

Joseph S. Stauffer Humanities and Social Sciences Library

Welcome to Stauffer Library. This guide leads you on a walking tour of the building and contains an overview of the Library's collections and services. Opened in 1994, this library is named after Joseph S. Stauffer, a Queen's graduate (Science, Class of 1920) and benefactor in recognition of his loyalty and generosity to the University. The building was designed by Kuwabara, Payne, McKenna, Blumberg Architects (Toronto) and built by Eastern Construction (Ottawa) at a cost of forty-two million dollars. Built of limestone from the Bruce Peninsula, the Library contains over 230,588 square feet of space distributed over six floors, five of which contain the library's collections, services and study space.

The Library is currently undergoing a renovation to the ground floor, and is expected to fully reopen in early 2025. Some of the exciting changes will be the significant expansion and improvements to the Adaptive Technology Centre; a new 50-seat library classroom; gender neutral washrooms; better zoned spaces for quiet study and active collaboration; and a new service desk.

The Joseph S. Stauffer Library is the Art & Music, Business, Humanities and Social Sciences library. It is also home to the Adaptive Technology Centre (temporarily relocated to Douglas Library), Data Services (including Research Data Management), Maps & Geospatial Data, Government Information, and Copyright and Scholarly Publishing.

Walk northwards towards the elevators or stairs to descend to the lower level.

On this floor are several specialized collections: government documents, multimedia, maps and air photos, and the microform collection. Single person study carrels are located on the west side on the floor. Research Stations are located to the south of the stairs.

1 Government Documents

Includes depository collections from the Canadian federal government, Ontario government, and United Nations

2 Microform Collection

The cabinets contain newspapers, journals, theses, government reports and more, which are on microfilm or microfiche. Readers are located near the Map and Air Photo Collection.

3 Multimedia Collection

Housed in this area is the Library's collection of CDs, DVDs (and some VHS tapes). The Library's many online streaming collections can be accessed via the Library's homepage. An adjacent bookable study room contains a TV, DVD player and VHS player.

Continue north to the Maps area.

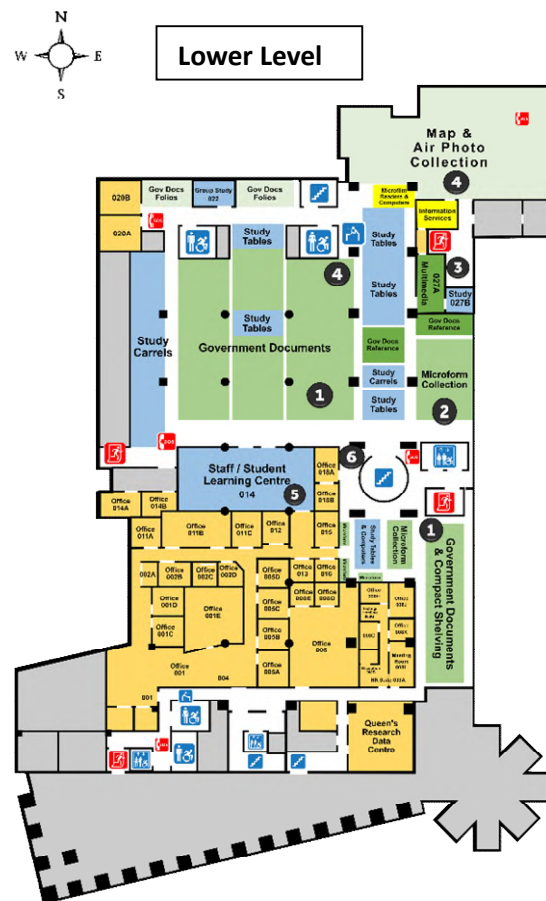

4 Map and Air Photo Collection

This collection includes GIS resources, topographical and thematic maps, air photos, and historical cartography materials.

Walk south towards the stairs and elevator. When you get to the stairs, turn and head west.

5 Staff/Student Learning Centre

Designed in consultation with the Office of Indigenous Initiatives, this beautiful space contains design elements reflecting Anishinaabe and Haudenosaunee cultures, on whose traditional lands Queen's is situated.

6 Data Services

Help with finding, using and managing data.

Walk towards the elevators or stairs to ascend to the second floor.

The **second floor** houses the bound journal collection, book stacks (A-D), and the Reference, Art and Music collections.

Bound journals are individual issues of past magazines or journals bound in hard covers. They are arranged in call number order and are shelved in the first and second rows.

The music collection is located at the north end of the floor in line with the first and second rows of bound journal shelving while the reference collection is located at the south end. The main book collection, arranged on the shelves in call number order, from A to D, begins in the third row. These books may all be checked out at Information Services. While the ground floor is closed, Information Services is located at the southwest corner of the second floor.

There are Research Stations beside the spiral staircase in the same location on the 2nd, 3rd and 4th floors of the Library.



Note the single person study carrels located along the atrium on both sides on this floor and in the same location on the 3rd and 4th floors.

The Prayer/Meditation Room, at the north end of the floor, is open to all for quiet retreat and reflection.

Walk to the northeast corner and you will find the Art Collection.

7 Art Collection

You will find exhibition catalogues, current art journals and art-related books and art conservation materials in this area. Bound art journals are integrated into the existing Stauffer Library bound journals collection. A Research Station and study tables are also available.

As you leave the art collection area, turn left and walk towards the reading rooms.

8 North and South Reading Rooms

You can find Research Stations in each reading room.

Continue walking south through the South Reading Room to the southeast wing to the Fireplace Reading Room.

9 Alan G. Green Fireplace Reading Room

This room is for library users who prefer to do their solitary reading, studying, or thinking in quiet surroundings. During nice weather, the terrace is also open.

Exit the Fireplace Reading Room, turn left and walk along the south side of the building to the Folios and Periodicals sections.

10 Folios

Note the journal and book folios collections shelved in the south part of the building. Folios are oversized books and bound journals which will not fit on the regular shelves. There are book folios in a similar location on the 3rd and 4th floors. Book folios can be checked out at Information Services.

11 Reference Collection

This collection contains encyclopedias, dictionaries, almanacs, directories, and other reference tools. These materials are for in-library use only. Many more reference materials are available online – contact your subject librarian for recommendations.

12 Print, Scan and Copy

Self-serve printers are located at the south end of the floor.

13 Bound Journals

Bound and unbound issues of journals are shelved by call number.

Continue walking towards the southwest corner of the building to the temporary location of Information Services.

14 Information Services Suite #201

One-stop for library help and referrals to subject librarians, circulation, reserves, and to pick up interlibrary loans. Use your Queen's ID card as your library card.

Walk along the west side of the building.

15 Humanities, Business & Social Sciences Department

Located along the west side of the floor are the offices of the Humanities, Business & Social Sciences liaison librarians. Services include providing research consultations and a range of supports for teaching and learning. Drop-in research help is available in Room 212, Monday-Friday. Check the library's website for service hours.

Walk towards the elevators or stairs to ascend to the third floor.



On the **third floor**, you will find books with call numbers DA through K.



Walk to the north-east corner of the building.

16 Helen Howard Graduate Students Reading Room

This space is available for the use of graduate students and includes several bookable small group study rooms.

Walk to the south-east corner of the building.

17 May Ball Study Lounge

This area has a variety of comfortable seating.

Walk towards the elevators or stairs to ascend to the fourth floor.

On the **fourth floor** are books with call numbers L through Z as well as the compact shelving collection (call numbers A – Z), located in the northwest section of the floor.

18 Compact shelving is a space saving device to move whole ranges of shelves with a mechanical assist system so that most aisles can be eliminated. Infrequently used materials are located here.

Study rooms and assigned study/research carrels are located on the third and fourth floors. Twelve of the study rooms have been given Indigenous names and feature artwork by Indigenous artists from Joyceville Institution that

incorporates the meanings of the new room names into their respective works. A designated movement space is located in the southwest corner of the fourth floor.

And... Interesting Library Facts & Figures

- the atrium is 80 feet high, 80 feet long and the width of a two-lane highway
- the whole building with its 6 floors occupies a total of 5 acres
- 285,000 pieces of limestone on the exterior of the building
- windows were made in Scotland
- the spiral staircase is suspended from the ceiling of the top floor
- the top floor is dedicated entirely to systems which maintain the building and is not open to the public
- decorative wood is from cultivated forests around the world: teak from Malaysia, mahogany from South America, cherry from Pennsylvania
- seating for 1100 library patrons
- 60 km. of shelving
- 135 map cabinets
- 10,972 m. of carpeting

For more information visit the Information Services Desk or our website at <https://library.queensu.ca/use-the-library/locations/joseph-s-stauffer-library>

Queen's University Library is situated on the territory of the Haudenosaunee and Anishinaabek. The Library is committed to an inclusive library community with accessible goods, services, and facilities that respect the dignity and independence of persons with disabilities.